

# 763101

Fitting 45° for PTFE+INOX hose

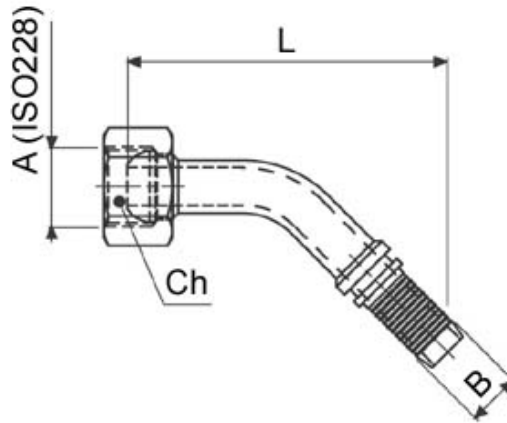

A	L	Diam B	Ch	Kg	CODE AISI 316L
1/8"	48	5	14	0,02	763101 60200
1/4"	60	7	19	0,04	763101 60300
3/8"	72	9,8	22	0,07	763101 60700
1/2"	85	13,2	27	0,11	763101 61100
3/4"	107	19,6	32	0,14	763101 61700
1"	130	26	41	0,36	763101 62300



**SCHIBUOLA LAURO**

Products for Plant Automation

[www.schibuola.com](http://www.schibuola.com) - [info@schibuola.com](mailto:info@schibuola.com)

tel. 011-6991507 - 011-6502223 cell. 3355367761

