

688006

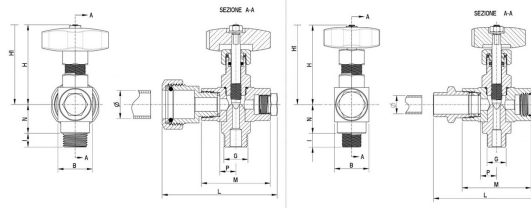

Upper and/or lower GAUGE-COCK
 Drive: Handwheel
 Connection: ISO 228 male thread
 Material: Aisi 316L
 Measure: from 3/8" to 1"
 Operating temperature: -50°C +200°C
 Outer finish: Polished

On request:
 • Connection for glass pipe in another measure



G	Ø	L	B	M	P	N	I	H	H 1	PN	Kg.	CODE AISI 316L
3/8"	12	85	30	56	14	25	12	72	80	16	0,50	688006 60600
3/8"	14	85	30	56	14	25	12	72	80	16	0,50	688006 60700
3/8"	16	85	30	56	14	25	12	72	80	16	0,50	688006 60800
1/2"	12	85	30	56	14	25	12	72	80	16	0,52	688006 61000
1/2"	14	85	30	56	14	25	12	72	80	16	0,52	688006 61100
1/2"	16	85	30	56	14	25	12	72	80	16	0,52	688006 61200
1/2"	24	100	30	60	14	25	12	72	80	16	1,06	688006 61600
1"	20	83	40	53	18	25	14	110	127	16	1,20	688006 62300

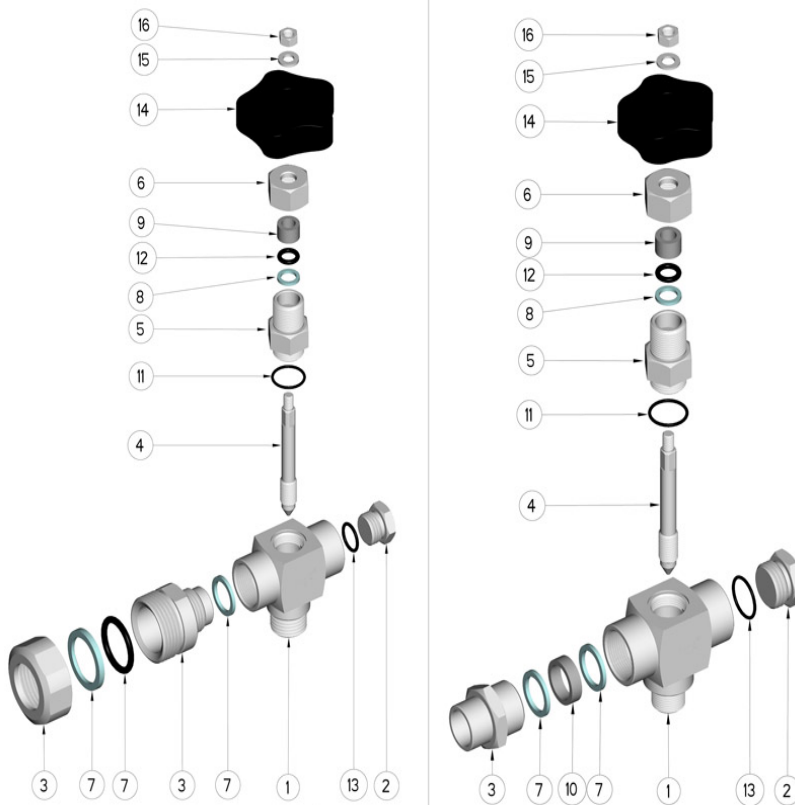

POS.	DENOMINATION	PCS	MAT.
1	Body	1	AISI 316L
2	Plug	1	AISI 316L
3	Stringivetro	1	AISI 316L
4	Asta Spillo	1	AISI 316L
5	Vitone	1	AISI 316L
6	Dado premistoppa	1	AISI 316L
7	Premiguarnizione	2	PTFE
8	Guarnizione	1	PTFE
9	Guarnizione	1	PTFE caricato vetro/with glass
10	Guarnizione tubo vetro	1	FKM
11	OR	1	FKM
12	OR	1	FKM
13	OR	1	FKM
14	Volantino	1	Duroplast
15	Washer	1	AISI 304L
16	Nut	1	AISI 304L

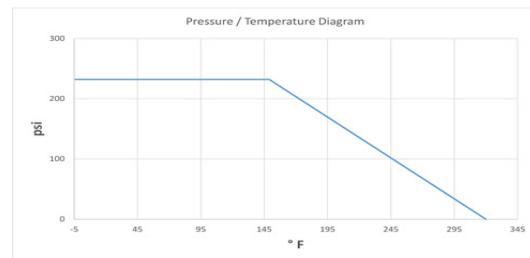
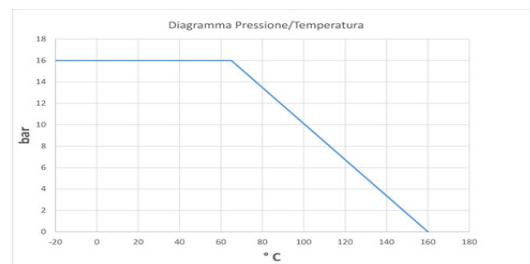

 **SCHIBUOLA LAURO**

Products for Plant Automation

www.schibuola.com - info@schibuola.com

tel. 011-6991507 - 011-6502223 cell. 3355367761

