

TECHNICAL DATA	
Delivery max	1650 l/Hour
Head max*	10 bar
Vacuum	0,95 bar
Delivery per revolution	0,34 Liters
Barb hose	DN 32
Free passage	25 mm
Weight	
Power Kw	0,37-0,75
Hose fiber reinforced available in different materials	NR
	NBR
	HYP
	EPDM
	NRA
Leakage sensor	Option
Cooling device	Option
Different connections	Option

VERSIONS AVAILABLE

Variables with mechanical speed variator, from 1:5 Variables with electronic inverter integrated IP 65

Variabili con inverter elettronico integrato IP 65

Trailers for slow hand towing in site

Electrical control panels aboard the machine

Note: in the presence of fluids particularly viscous, suspensions coarse solid, high delivery pressure, high temperatures, consider operate not more than 30 % of the maximum flow rate of the pump.

*According to the transmission applied

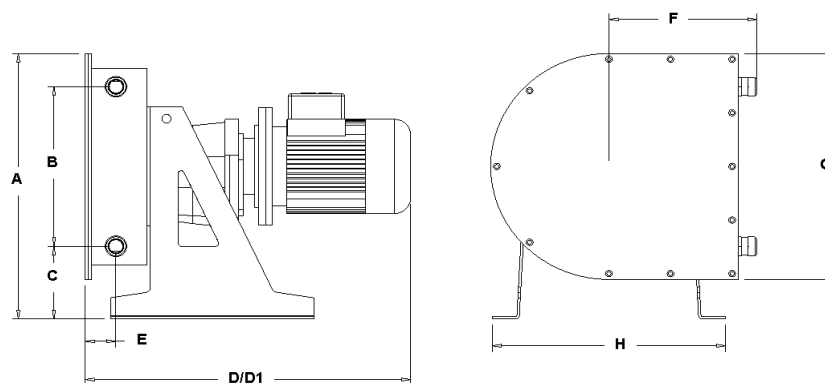

DIMENSIONS											
A	B	C	D	D1(VAR)	E	F	G	H	I	Out/In	Weight
450	272	123	530	660	50	240	384	380	-	DN 32	

The dimensions are not binding and can vary without notice

Hose Carrier HCP 25 - General pump data

TECHNICAL FEATURES: Flow rate	Hose Carrier HCP 25 pump
Pressure	up to 1650 liters per hour
Aspiration	up to 10 bar
Free passage	up to 9.5 meters
Compact solid passage	diameter 25 mm
Mouths	diameter 4 mm hose connection DN 32 mm
Applied power	0.37 - 0.75 kW
Voltage	Mono - Three phase
Maximum dimensions	H 450 x 660 x 420
Weight	kg.
Tubular membrane	NR – NBR HYP – EPDM – SIL – (FDA)

THE EXCLUSIVE ADVANTAGES of the Hose Carrier HCP 25 pump:



- Economical purchase and operation.
- • Ability to prime and run dry without damage.
- • Online reversibility.
- • High vacuum capacity up to 9.5 meters.
- • Absence of valves or seals, rotors and stators that wear out.
- • Simple on-site maintenance without piping removal.
- • No contact between mechanical parts and pumped fluid.
- • Pump body in treated steel or stainless steel.
- • Rotor with two rollers mounted on bearings lubricated for life.
- • Rollers with optional bearing protection.
- • Double body versions.
- • Direct flanged gearmotor or with dedicated autonomous support.
- • Hose containment loops to extend its life.
- • Forced grease or Lubex lubrication system.
- • Pipe break control kit.

 **SCHIBUOLA LAURO**

Products for Plant Automation

www.schibuola.com - info@schibuola.com

tel. 011-6991507 - 011-6502223 cell. 3355367761

