

Hose Carrier HCP

PRODUCT INFORMATION

Hose Carrier HCP 40

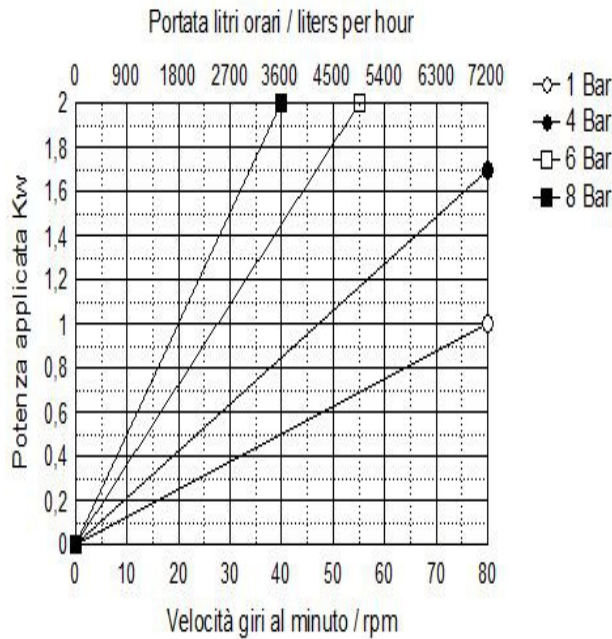

DATI TECNICI	
Delivery max	7000 l/Hour
Head max*	8 bar
Vacuum	0,95 bar
Delivery per revolution	1,5 liters
Barb Hose	DN 50
Free passage	40 mm
Weight	
Power Kw Kw	0,5 – 2
Hose fiber reinforced available in different materials	NR
	NBR
	HYP
	EPDM
	NRA
Leakage sensor	Option
Cooling device	Option
Different connections	Option

VERSIONS AVAILABLE

Variables with mechanical speed variator, from 1:5

Variable electronic inverter integrated IP 65

Trailers for slow hand towing in site

Electrical control panels aboard the machine

Note: in the presence of fluids particularly viscous, suspensions coarse solid, high delivery pressure, high temperatures, consider operate not more than 30 % of the maximum flow rate of the pump. *According to the transmission applied

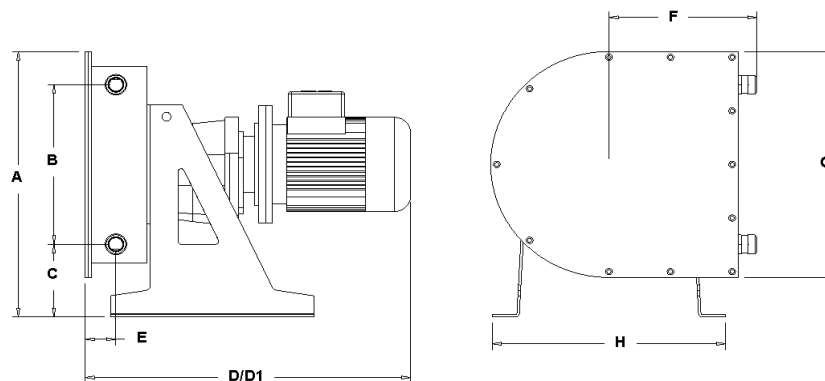

DIMENSIONS											
A	B	C	D	D1(VAR)	E	F	G	H	I	Out/In	Weight
660	440	145	652	840	76	361	592	506	-	DN 50	

The dimensions are not binding and can vary without notice

General data of the Hose Carrier HCP 40 pump

TECHNICAL FEATURES:

Flow rate	Hose Carrier HCP 40 pump up to 7000 liters per hour
Pressure	up to 8 bar
Aspiration	up to 9.5 meters
Free passage	diameter 40 mm
Compact solid passage	diameter 7 mm
Mouths	hose connection DN 50 mm
Applied power	1.1 - 2 kW
Voltage	Mono - Three phase
Maximum dimensions	H 660 x 840 x 657
Weight	kg.
Tubular membrane	NR – NBR HYP – EPDM – SIL – (FDA)

THE EXCLUSIVE ADVANTAGES of the Hose Carrier HCP 40 pump:



- Economical purchase and operation.
- Ability to prime and run dry without damage.
- Online reversibility.
- High vacuum capacity up to 9.5 meters.
- Absence of valves or seals, rotors and stators that wear out.
- Simple on-site maintenance without piping removal.
- No contact between mechanical parts and pumped fluid.
- Pump body in treated steel or stainless steel.
- Rotor with two rollers mounted on bearings lubricated for life.
- Rollers with optional bearing protection.
- Optional retractable roller device.
- Double body versions.
- Direct flanged gearmotor or with dedicated autonomous support.
- Hose containment loops to extend its life.
- Forced grease or Lubex lubrication system.
- Pipe break control kit.
- Mechanical or electrical vacuum device for dense fluids.



SCHIBUOLA LAURO

Products for Plant Automation

www.schibuola.com - info@schibuola.com

tel. 011-6991507 - 011-6502223 cell. 3355367761

