

SWING CHECK VALVES

SERIES CS

 RED LINE

marine and offshore
industry /
petrochemical
industry /
general plants



CE In compliance with PED 97/23/EC

TECHNICAL DETAILS

Wafer design

Self-centering

Light weight and small face to face

Low pressure drops

Easy to install and maintenance

Standard materials: zinc plated carbon steel, stainless steel 316, alu-bronze

Metal/metal seat or soft seal (NBR, EPDM, PTFE, FKM)

Series DN 32 ÷ DN 350

Suitable for flanges EN1092-1:2001 PN6, 10, 16, 25 and ANSI150 RF

Further materials and special executions upon request: series ANSI300 ÷ ANSI1500 RF e RTJ
series PN40 ÷ PN250

APPLICATIONS



MARINE AND
OFFSHORE
INDUSTRY



PETROCHEMICAL
INDUSTRY



HEATING



VENTILATION



FIRE
PROTECTION
SYSTEM



WATER
INDUSTRY

WORKING PRESSURE

PN 6	6 Kg/cm ²	85 Psi
PN 10	10 Kg/cm ²	142 Psi
PN 16	16 Kg/cm ²	227 Psi
PN 25	25 Kg/cm ²	355 Psi
ANSI 150	20 Kg/cm ²	284 Psi

**MINIMUM
OPENING PRESSURE
(mbar)**

		DN 32 : DN 150	DN 200 : DN 300
Flow Direction			
Horizontal open 10°	→	13	15
Horizontal open 30°	→	19	25
Horizontal open 60°	→	23	32
Vertical uphill	↑	26	35
Vertical downhill	↓	10	10

TECHNICAL DRAWINGS

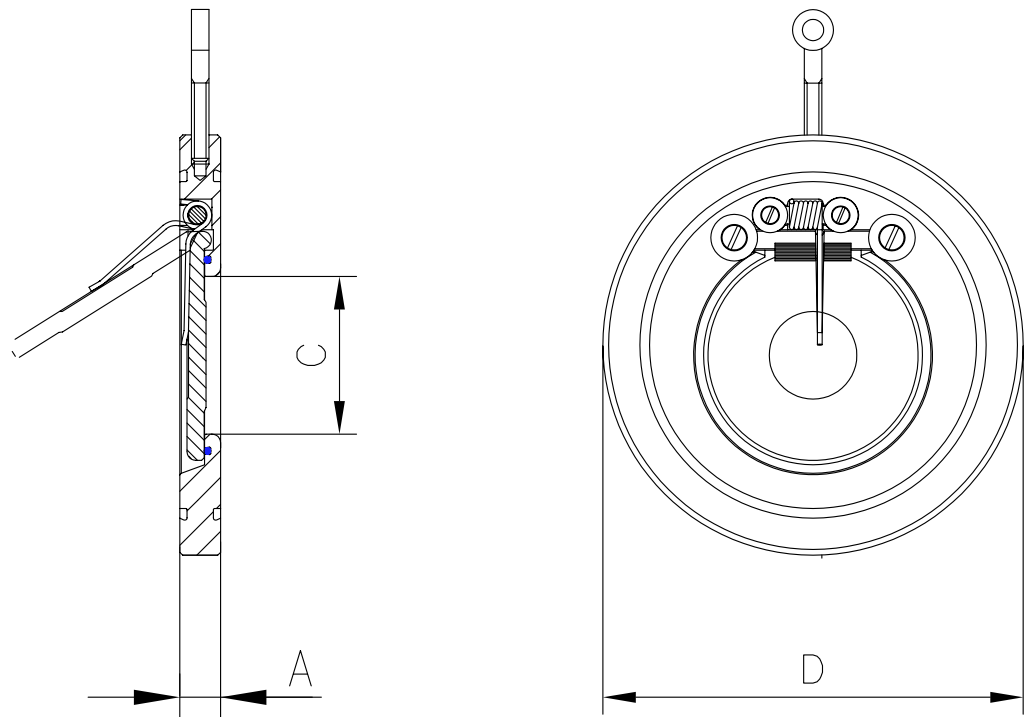

DIMENSIONS

DN		A	C	D					D ANSI 150	WT PN10 Kg
mm	inch			PN6	PN10	PN16	PN25			
32	1" 1/4	14	17	78	84	84	84	76	0,6	
40	1" 1/2	14	22	88	95	95	95	86	0,7	
50	2"	14	32	98	109	109	109	105	0,9	
65	2" 1/2	14	40	118	129	129	129	124	1,2	
80	3"	14	54	134	144	144	144	137	1,5	
100	4"	18	70	154	164	164	170	175	2,4	
125	5"	18	92	184	195	195	198	195	3,4	
150	6"	20	112	209	220	220	228	220	4,6	
200	8"	22	154	264	275	275	285	279	7,5	

TECHNICAL DRAWINGS

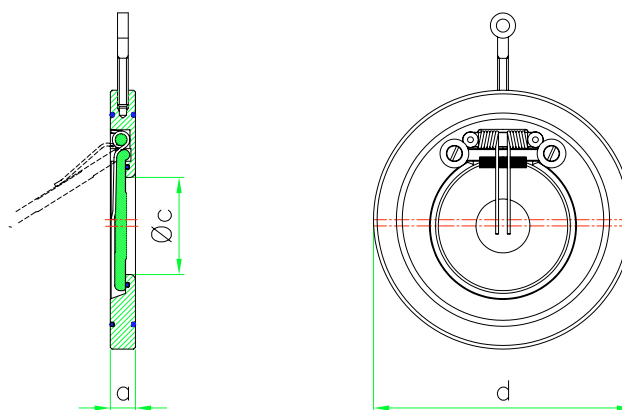

DIMENSIONS

DN		A	C	D					D ANSI 150	WT PN10 Kg
mm	inch			PN6	PN10	PN16	PN25			
250	10"	26	200	319	330	330	340	340	13,1	
300	12"	32	240	375	380	387	403	410	20,4	
350	14"	38	270	425	440	448	460	448	32	

MATERIALS

Pos	Component	Q.ty	Material	T max °C	T min °C
1	Body	1	Carb. steel	+250	-10
			SS 316L	+510	-50
			Alu-bronze	+260	-10
2	Disc	1	Carb. steel	+250	-10
			SS 316L	+510	-50
			Alu-bronze	+260	-10

Pos	Component	Q.ty	Material	T max °C	T min °C
3	Washer	2	AISI 316	+510	-50
4	Screw	2	AISI 316	+510	-50
5	Ext O-ring	2	NBR	+120	-20
			EPDM	+130	-30
			FKM	+260	-50
			PTFE	+260	-50
6	Int O-ring	1	As Ext O-ring		
7	Eyebolt	1	Carb. steel	+250	-10
8	Spring shaft	1	AISI 316	+510	-50
9	Spring	1-2	AISI 316	+510	-50
10	Spring screw	2	AISI 316	+510	-50