

| TECNICAL DATA | |
|--|--------------|
| Delivery max | 12000 l/HOUR |
| Head max* | 10 bar |
| Vacuum | 0,95 bar |
| Delivery per revolution | 2,79 liters |
| Barb hose | DN 60 |
| Free passage | 50 mm |
| Weight | |
| Power Kw | 1,0-3,0 |
| Hose fiber reinforced available in different materials | NR |
| | NBR |
| | HYP |
| | EPDM |
| | NRA |
| Leakage sensor | Option |
| Cooling device | Option |
| Different connections | Option |

VERSIONS AVAILABLE

Variables with mechanical speed variator, from 1:5

Variable electronic inverter integrated IP 65

Trailers for slow hand towing in site

Electrical control panels aboard the machine

Note: in the presence of fluids particularly viscous, suspensions coarse solid, high delivery pressure, high temperatures, consider operate not more than 30 % of the maximum flow rate of the pump. *According to the transmission applied

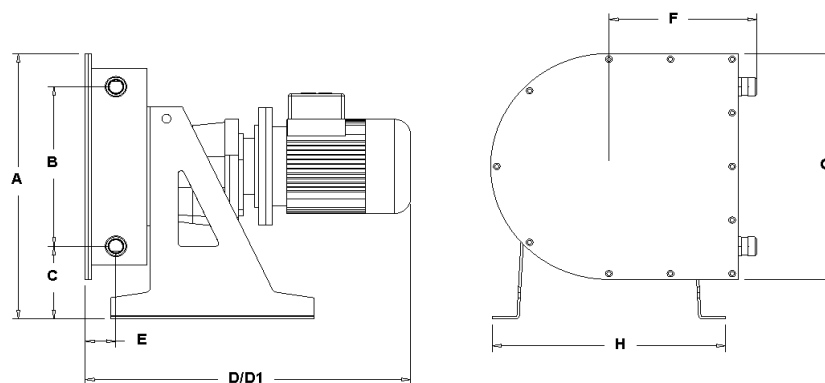

| DIMENSIONS | | | | | | | | | | | |
|------------|-----|-----|-----|---------|----|-----|-----|-----|---|--------|--------|
| A | B | C | D | D1(VAR) | E | F | G | H | I | Out/in | Weight |
| 780 | 524 | 170 | 723 | 931 | 81 | 418 | 696 | 598 | - | DN 60 | |

Le dimensioni non sono impegnative e possono variare senza avviso

General data of the Hose Carrier HCP 50 pump

TECHNICAL FEATURES:

| | |
|-----------------------|---|
| Flow rate | Hose Carrier HCP 50 pump up to 12000 liters per hour |
| Pressure | up to 10 bar |
| Aspiration | up to 9.5 meters |
| Free passage | diameter 50 mm |
| Compact solid passage | diameter 10 mm |
| Mouths | hose connection DN 65 mm |
| Applied power | 1.5 - 3 kW |
| Voltage | Mono - Three phase |
| Maximum dimensions | H 780 x 931 x 766 |
| Weight | kg. |
| Tubular membrane | NR – NBR HYP – EPDM – SIL – (FDA) |

THE EXCLUSIVE ADVANTAGES of the Hose Carrier HCP 50 pump

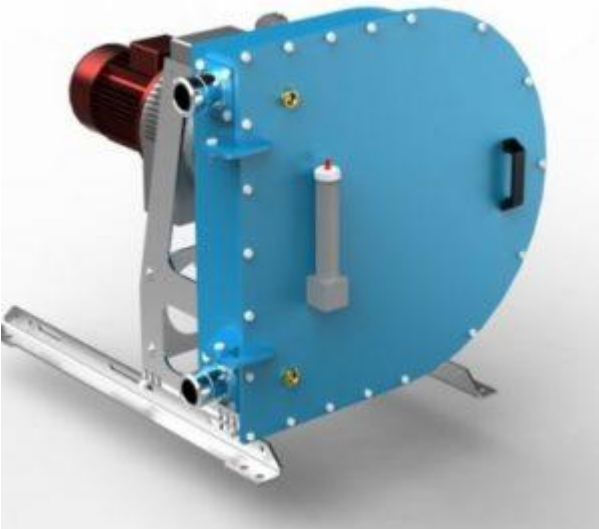

- Economical purchase and operation.
- Ability to prime and run dry without damage.
- Online reversibility.
- High vacuum capacity up to 9.5 meters.
- Absence of valves or seals, rotors and stators that wear out.
- Simple on-site maintenance without piping removal.
- No contact between mechanical parts and pumped fluid.
- Pump body in treated steel or stainless steel.
- Rotor with two rollers mounted on bearings lubricated for life.
- Rollers with optional bearing protection.
- Optional retractable roller device.
- Double body versions.
- Direct flanged gearmotor or with dedicated autonomous support.
- Hose containment loops to extend its life.
- Forced grease or Lubex lubrication system.
- Pipe break control kit.
- Mechanical or electrical vacuum device for dense fluids.

 **SCHIBUOLA LAURO**

Products for Plant Automation

www.schibuola.com - info@schibuola.com

tel. 011-6991507 - 011-6502223 cell. 3355367761

